

Activating the B444-C



NOTICE!

The B444-C communicator must be activated and have a valid cellular plan for proper usage.

The activation process assigns a phone number, IP address, and a data plan to the communicator. Activation occurs using one of three methods:

1. Using the cellular activation tools in RPS.
2. By submitting a support ticket in the Bosch Cellular Portal email at: installer.services@us.bosch.com.
3. Calling Bosch Installer Services (800-289-0096). Please provide the IMEI and ICCID numbers found on the box or on the communicator for activation.

****A valid Bosch Installer Services account is required for activation.**

en

For the Conettix Plug-in cellular module text-based installation guide and other documentation, go to: www.boschsecurity.com

Region	Agency	Certification	
USA	CSFM	California State Fire Marshall	
	FCC	FCC, Part 15 Class B	
	UL	UL 365	
		UL 636	
		UL 864	
		UL 985	
		UL 1023	
		UL 1076	
	UL 1610		
Verizon	Open Development Certified		

Copyright

This document is the intellectual property of Bosch Security Systems, Inc., and is protected by copyright. All rights reserved.

Trademarks

All hardware and software product names used in this document are likely to be registered trademarks and must be treated accordingly.

Bosch Security Systems, Inc. product manufacturing dates

Use the serial number located on the product label and refer to the Bosch Security Systems, Inc. website at <http://www.boschsecurity.com/datecodes/>.



Conettix Plug-in cellular
module VZW LTE
B444/B444-C



en Installation Manual

Bosch Security Systems, Inc.
130 Perinton Parkway
Fairport, NY 14450
USA

www.boschsecurity.com

Bosch Sicherheitssysteme GmbH
Robert-Bosch-Ring 5
85630 Grasbrunn
Germany

1

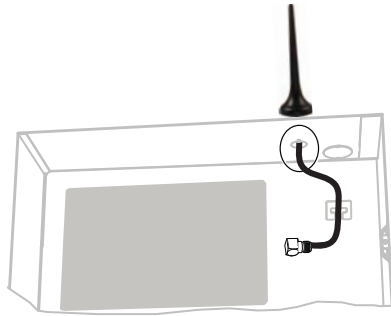

2

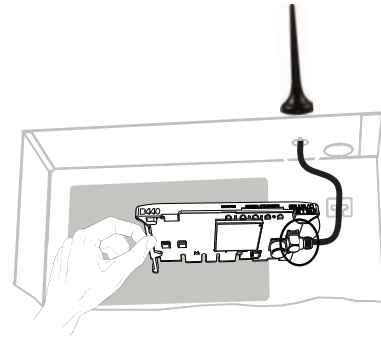

3

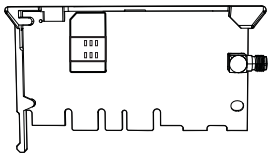
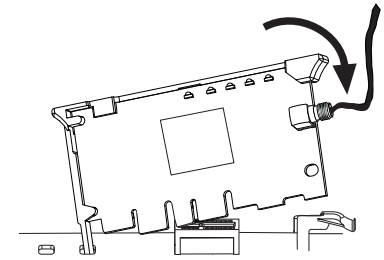

4



RPS

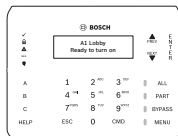

For detailed documentation, go to:
www.conettix.com/Cellular.aspx >
 Cellular Portal Login

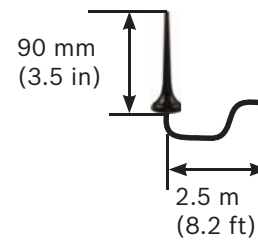
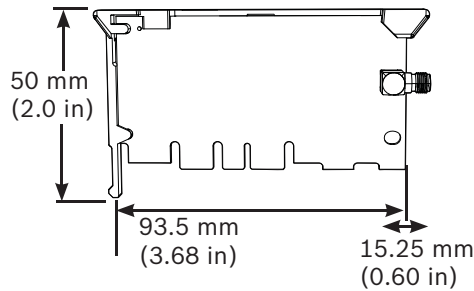

0°C to +49°C
 (+32°F to +120°F)



0% to 93%
 non-condensing

12 V nominal 12 
 23 mA standby
 85 mA maximum



2 Bands LTE CAT1 B4, B13; 750/1700/2100 MHz

